

*S*unseeker motoryachts
introducing the Manhattan 52

Fifty two
52



TRULY GLOBAL

Sunseeker Manhattan 52 - Standard specifications

1 Construction

Hand-laid GRP
Gel coat including stripes
Vinylester skin coat with powderbound mat
Stitched multi-axial reinforced single skin bottom
Balsa cored hull topsides
PVC foam cored deck and superstructure
Hull stiffened with longitudinal stringers supported by transverse bulkheads and floors

2 Deck

Fittings all in stainless steel
8 x deck cleats in stainless steel
Delta anchor and 60m chain (galvanised)
Electric winch and capstan 24v with deck and cockpit controls 24v
Sternhead roller and anchor stop
Self draining chain locker-fender stowage
Pulpit and cockpit rails in stainless steel
Stainless steel fendering with rubber insert
IMCO navigation lights
2 x Pantograph wipers 24v, windscreen washers
Ensign staff and socket
6 x fenders and 4 warps
Remote spotlight 24v
Curved safety glass windscreen

3 Bathing platform

Hydraulic fall and rise system
Fresh-water marina connection
Dockside AC shore power connection
Hot and cold swimming shower
Teak-laid bathing platform
Foldaway stainless steel swimming ladder

4 Aft cockpit

Self draining
Moulded staircase to flybridge
Upholstered seating with stowage underneath
Transom safety door
Engine room access hatch
Overhead lighting 24v
Teak-laid cockpit and steps
Cockpit speakers
Boat hook
Hand-held fire extinguisher

5 Flybridge helm position

Self draining
Deflecting screen (acrylic)
Hydraulic steering
Sports steering wheel
Duplicate engine controls and instrumentation
Compass
Trim tab control
Echo sounder and speedlog repeaters
Autopilot and GPS navigator controls
Instrument cover
6 x upholstered seating
Storage below seats
Cockpit table
Sunbathing area
Stainless steel guard rails and grab rails
Glass holders
Radio/CD remote control
Cockpit speakers

6 Saloon

Dining area with folding dining table
Scatter cushions
Saloon loose chair
Stainless steel sliding cockpit door to aft cockpit
Drinks cabinet
Flatscreen television on rise-and-fall system
Radio/CD/DVD surround system
Halogen overhead lighting 24v
Step lights 24v
Double AC socket
Choice of lacquered interior finishes and veneer
Fitted carpet

7 Galley

Sink and drainer
Electric refrigerator
Electric freezer
Ceramic 3-ring hob
Hob extractor fan
Microwave oven
Rubbish bin
6 place crockery set
6 place cutlery set
Cupboard and drawer storage
Double AC socket
Hand-held fire extinguisher
First aid kit

8 Main helm console

Upholstered double helm seat
Console with burr walnut type fascia
Hydraulic steering
Sports steering wheel
Radar/plotter
Autopilot
VHF radio dual station
Full analogue engine instrumentation
Electric speedlog
Depth sounder
Rudder indicator
Compass
Horn
Windscreen wipers and washers
Trim tab controls
Cigar lighter
Glass holders
Hand-held fire extinguisher

9 Master aft cabin

Double berth with storage and drawers beneath
2 x reading lights 24v
Outboard shelving
Bedside cupboards
Hanging wardrobe with mirrored door
Halogen overhead lighting 24v
2 x opening and 4 x large fixed portholes
Double AC socket
Flatscreen television
Fitted carpet

10 Master en suite shower room and toilet

Vacuum toilet
Avonite counter top
Shower taps and accessories
Washbasin
Separate shower compartment
Extractor fan
Razor socket 240/110v
Mirrored cupboard
Towel rail
Bath and hand towels
Halogen overhead lights
Opening porthole with venetian blind
Door to stateroom

11 Starboard guest Pullman cabin

2 x single Pullman type fixed berths
Under-berth stowage
Hanging wardrobe
Halogen overhead lights
Opening porthole with mosquito screen and curtain
Double AC socket
Flatscreen television
Fitted carpet

12 Forward VIP guest cabin

Double berth with storage and drawers beneath
2 x reading lights 24v
Outboard shelving
Hanging wardrobe with mirrored door
Halogen overhead lighting 24v
Opening portholes and curtains
Deck hatch
Double AC socket
Flatscreen television
Fitted carpet

13 Starboard VIP shower and toilet/day head

Vacuum toilet
Avonite counter top
Shower taps and accessories
Washbasin
Separate shower compartment
Extractor fan
Razor socket 240/110v
Mirrored cupboard
Towel rail
Bath and hand towels
Halogen overhead lights
Opening porthole with venetian blind

14 Engine compartment and ancillaries

Twin engines with direct drive gearboxes
2 x separate fuel filters water separators
Aluminium fuel tanks with electric sender units
Fresh-water engine top-up hose
Sound insulation throughout engine room
Automatic fire extinguisher
2 x automatic bilge pumps
1 x automatic flood pump
Bilge water high level alarm
Extractor fans 24v
Manual bilge pump

15 Electrical system

Generator with underwater silent exhaust
AC dockside connection
Main DC and AC electrical circuits protected by re-settable circuit breakers
Systems monitoring panel
Galvanic isolator
6 x batteries for engine starting 24v circuit
4 x batteries for domestic power 24v circuit
2 x batteries for generator starting 12v circuit
Battery coupling system
Battery switches controlled from locker in cockpit
Alternator split charging system
Battery charger for 24v circuits
Battery charger for 12v circuits
Water heater
AC outlet sockets throughout the boat

16 Underwater gear

Direct shaft drive through half tunnels
4-bladed NAB bronze propellers
Bronze P-brackets
2 x stainless steel shafts
Dripless shaft logs
High-performance bronze rudders and struts
Seawater strainers x 2 main engines / 1 x generator
Seacocks on all underwater fittings
Stainless steel trimtabs (hydraulic)
Full cathodic bonding system to zinc anodes

17 Systems

Aluminium fresh-water tank
24v fresh-water pressure system
Hot water tank
24v vacuum toilet system

18 Miscellaneous

Toolkit
Boat hook
4 x mooring ropes
6 x fenders
Spare bulbs and fuses
2 x towel sets

19 Optional extras

Stern crew cabin (with single berth, toilet and washbasin)
Washing machine
Passerelle
Teak flybridge decking

US specification includes:

Air-conditioning
Upgraded generator
US specification appliances

52 *Fifty two*

PRINCIPAL CHARACTERISTICS

Classification	CE	
Length overall – (incl. pulpit and transom platform)	17.60m	57' 9"
Beam – (maximum)	4.63m	15' 2"
Draft – (@ full load incl. props)	1.26m	4' 2"
Displacement – (@ half load)	25200kg	55440lb
Fuel capacity	2140 litres	565 US gal.
Fresh-water capacity	625 litres	165 US gal.
Black-water capacity	132 litres	35 US gal.
Propulsion	Twin fixed-pitch propellers	
Generators – standard	1x 9kW @ 50Hz 230v single phase (Euro) 1x 13kW @ 60Hz 120/240v single phase (US)	
Maximum speed	up to 32 knots*	
Cruising speed	up to 23 knots*	
Range	up to 250 nautical miles*	

All principal characteristics and specifications are provisional and subject to final specification.

LAYOUT OPTIONS

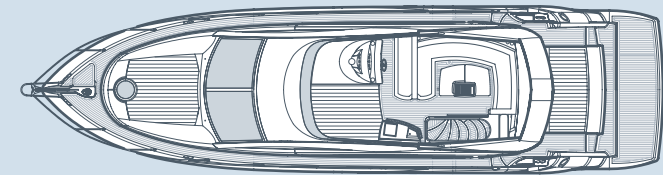

Flybridge

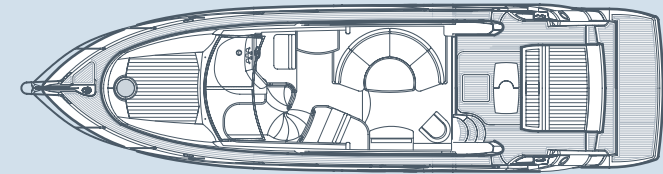

Main deck

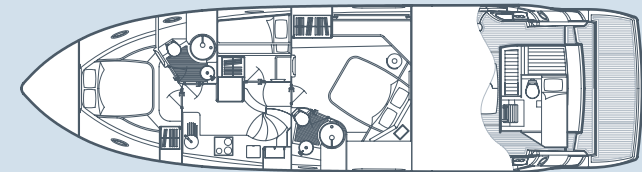

Lower deck





TRULY GLOBAL

www.sunseeker.com

Awards

Sunseeker's success over the years is clearly underlined by the following list of national and international awards and achievements.

2010	European CEO Corporate Lifestyle Awards	Best Luxury Yacht Company	2004	Sydney Boat Show	Best Marina Display
2010	ShowBoats Design Awards	Predator 130 'Evil Zana' – Winner (Naval Architecture)	2003	Australian Marine Awards	Manhattan 56, Award for Excellence
2010	Quintessentially Awards	Yacht charter of the year	2003	Australian Marine Awards	Predator 68, Best Imported Non-Trailable Yacht
2010	Sydney Boat Show	Boating Industry Association of NSW – Best Marina Display	2002	Entrepreneur of the Year Award	Robert Braithwaite MBE
2010	Sydney Boat Show	Boating Industry Association of NSW – Best Overall Display	2001	Best Power Design Award	105 Yacht, The Superyacht Society
2010	Asia Boating Awards	Predator 60 – Best Production Motor Yacht 51 to 80 feet	2001	Best Power Interior Award	105 Yacht, The Superyacht Society
2009	Sydney Boat Show	Display of Excellence	2001	President's Award	Southern California Marine Association
2009	Croatia Boat Show	Predator 92 Sport – best in class	2000	Queen's Award for Enterprise	Continuous innovation and development
2009	Croatia Boat Show	30 Metre Yacht – best in class	2000	The Times Exporter of the Year	Times Export Awards
2009	Croatia Boat Show	Best boat show stand	2000	Robb Report Award	Best of the Best, Boating and Sailing
2008	UK Motor Boat of the Year Awards	Manhattan 60	1999	Robb Report Award	Best of the Best, Boating and Sailing
2007	European Powerboat of the Year	Superhawk 43	1999	Motorboat of the Year	Predator 75, BT British Nautical Awards
2007	Asia Pacific Boating Awards	90 Yacht, Best of the Best	1998	Superyacht Design Award	Manhattan 74, Superyacht Design Awards
2007	Modern Boating Magazine	Portofino 47, Imported Powerboat of the Year	1998	Editor in Chief Awards	Yachts Magazine
2007	Australian Marine Industries Federation Awards	Predator 62, Imported Powerboat of the Year	1997	Lifetime Achievement Award	Robert Braithwaite MBE, RYA Awards
2007	Nominated by The Superyacht Society	37 Metre Yacht 'The Snapper'	1996	Motorcruiser of the Year Award	RYA British Nautical Awards
2007	Queen's Award for Enterprise	International Trade	1996	Exporter of the Year Award	DCCI Export Awards
2006	Nominated for three Superyacht Awards	Predator 108 'SHIVER'	1995	Boat Builder of the Year Award	RYA/BMIF British Nautical Awards
2005	Australian Marine Industries Federation Awards	75 Yacht, Non-Trailable Boat Award	1994	Queen's Award for Export Achievement	Queen's Awards for Industry
2005	Australian Marine Industries Federation Awards	Portofino 46, Commendation	1992	Best in the World Award	Renegade 60, Boating Magazine
2005	Modern Boating, Power Boat of the Year Awards	Predator 68, Imported Powerboat of the Year	1990	Exporter of the Year	SW International Business Awards
2005	Boats.com Marine Industry Web Awards	Manufacturers Category for www.sunseeker.com	1989	Queen's Award for Export Achievement	Queen's Awards for Industry
2004	Sydney Boat Show	Best Overall Display	1987	Queen's Award for Export Achievement	Queen's Awards for Industry



Sunseeker International Limited has CE Approval which is compulsory for all boats with a LOA of 24m and below when sold in the EU.

*Every attempt has been made to give accurate information, but performance and range figures are estimates given as a guide only. Dirt or growth on the hull, tuning of the engines, size, make of engines fitted, damage to propellers, the temperature of the air and water, the weight of fuel, water, stores, number of people, propeller pitch, quality of fuel and other matters, can all affect a boat's performance and range. For these and other reasons we can give no performance, range or other guarantees, and neither such guarantees nor anything contained herein constitutes an offer of contract or any representation or agreement, or may otherwise be relied upon. The photographs and artist's impressions in this brochure are from existing models in the Sunseeker range. There may be items shown in these photographs and artist's impressions that are not included in the standard inventory of the models shown. Specifications contained in this brochure are provisional only and should not be relied upon and may refer to models only intended for sale in a particular territory and not generally. No guarantee is given that any model will be available in any territory; however by contacting us we can advise you of models that are likely to be available in each territory. In some examples herein we have referred to measurements, specifications or other details applicable to a particular territory and no guarantee is given that these are applicable to your territory. Actual specifications will be provided when a sales order or enquiry is placed with us or our approved Sunseeker distributor. Specifications for models sold in different markets may vary and specifications and models may be changed or withdrawn at any time without prior notice. The individual specification for each vessel will be agreed as part of the sale contract between the purchaser and the Sunseeker distributor. Distributors are independently owned and operated entities, and therefore Sunseeker distributors are not owned by Sunseeker International Limited or any subsidiaries or other related entity of this company nor are they their agents. Therefore they have absolutely no authority to commit Sunseeker International Limited, or any subsidiary or other related entities of Sunseeker International Limited to any pledge, contract or agreement in any form or by any means unless first accepted in writing by Sunseeker International Limited. For ease of reference we have, in some cases, referred to "we" or "Sunseeker" and these terms should be taken to mean Sunseeker International Limited.